

Q1-Q2 2024



BelRed District Major Projects List

This List is intended to be a "snapshot" of development (proposed through construction) within Bel Red District. If you have questions regarding any of the projects on this List, contact the City of Bellevue Contact (Land Use Planner) listed for that project.



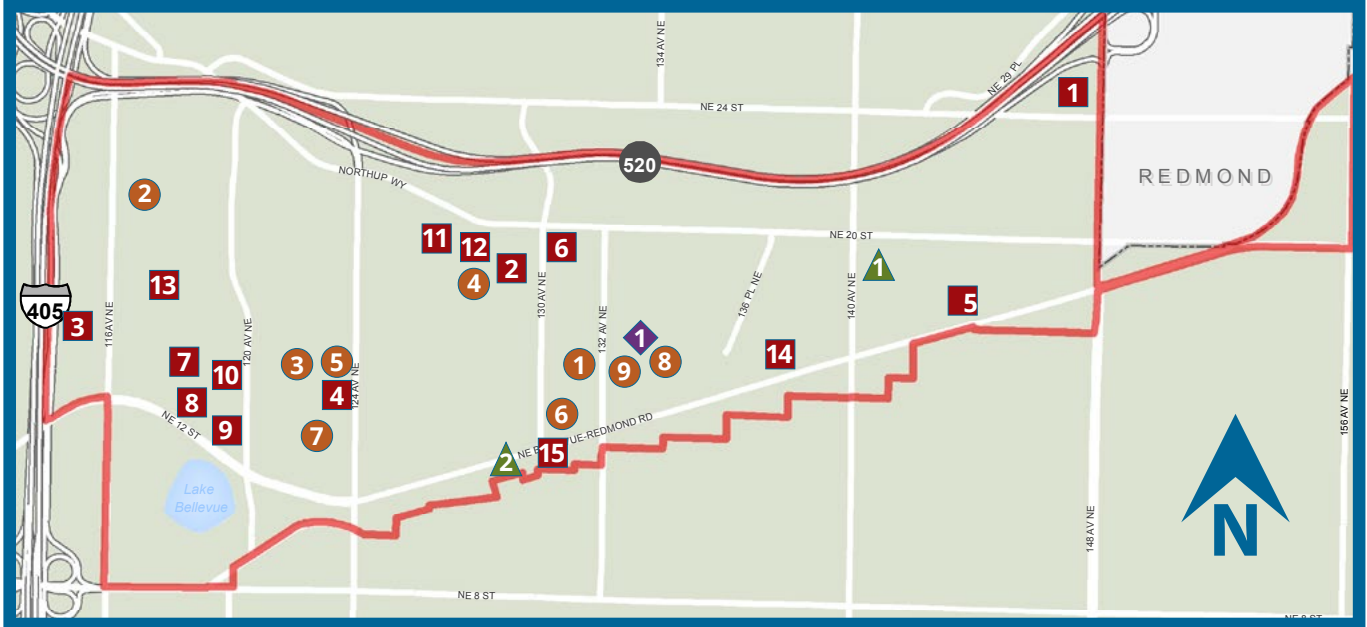

In Review – Land Use & Building

Projects currently undergoing Entitlement Review (Design Review, Master Development Plan, Administrative Conditional Use or Conditional Use) or Building (Construction) Permit Review.

1. **Brown Bear Car Wash (Building Permit) | 2421 148th Avenue NE**
2. **Holland Chambers Apartments (Design Review) | 1831 130th Avenue NE**
3. **Life Zone Senior Medical (Design Review) | 11504 NE 21st Street**
4. **Spring District – Block 15 (Design Review) | 12343 NE Spring Boulevard Lot 15**
5. **Amity Court (Design Review) | 14400 NE Bellevue-Redmond Road 22 114102**
6. **Stellar (Design Review) | 13031 NE 20th Street**
7. **ACST - Bellevue (MDP Amendment) Pine Forest | 1445 120th Avenue NE**
8. **ACST - Bellevue Phase 1 (Design Review) Gables | 1445 120th Avenue NE**
9. **ACST - Bellevue Phase 2 (Design Review) Building A | 1215 120th Avenue NE**
10. **ACST - Bellevue Phase 3 (Design Review) | 1197 NE Spring Blvd / 1425 10th Avenue NE**
11. **88 Degrees (Building Permit) | 1733 127th Avenue NE**
12. **Springvue Townhomes (MDP, Design Review, Critical Areas Land Use Permit) | 12727 Northup Way**
13. **Bridge OMFE Affordable Housing (Design review) | 1899 120th Avenue NE**
14. **KOZ on Bel-Red (Design Review) | 13800 NE Bel-Red Road**
15. **91 Degrees Townhomes (Design Review Critical Areas Land Use Permit) | 12951 NE Bel-Red Road**

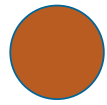

Under Construction

1. East Link 130th Station | Spring Boulevard (between 130th & 132nd Avenue NE)
2. RJ Development Senior Housing | 2120 116th Avenue NE
3. East Link Spring District/120th Station | North of Spring Boulevard between 120th & 124th Avenues NE
4. Northup Way Mixed Use | 12863 Northup Way
5. Spring District – Block 5 | 1615 123rd Avenue NE, Lot 5
6. Big 1 Residential | 13000 NE Bellevue Redmond Road
7. Spring District – Block 13 | 1325 123rd Avenue NE
8. Ondina | 1600 132nd Avenue NE
9. Bellevue Station | 1525 132nd Avenue NE

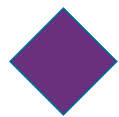

In the Pipeline (Pre-application Conference held)

Projects have received early guidance through the Preapplication Conference, but have not yet applied for Entitlement Review.

1. 13201 NE Spring Blvd MDP



Issued

Projects have received Entitlement Review but no construction permits have been issued.

1. SummerHill Highland Park (Design Review & Critical Areas Land Use Permit)
14125 NE 20th Street
 2. Executive Plaza Townhomes (Design Review) | 12835 NE Bellevue-Redmond Road
-

In Review – Land Use and Building

1. Brown Bear Car Wash

2421 148th Avenue NE

Building Permits:

22-101539-BW & 22-115507-BW

- 1,800 SF Car Wash
- 1,800 SF Retail
- Gas Station Facility

Contact: Caitlin Hepworth:

425-251-6222 x7360

City of Bellevue Contact: Kimo Burden

425-452-5242 or cburden@bellevuewa.gov



2. Holland Chambers Apartments

1831 130th Avenue NE

Design Review: 22-102857-LD

- Multi-Family Residential
- 7 Stories
- 238 Residential Units
- 187 Parking Spaces

Contact: Yujia Ren 470-767-0908

City of Bellevue Contact: Drew Folsom

425-452-4441 or

wwdfolsom@bellevuewa.gov



3. Life Zone Senior Medical

11504 NE 21st Street

Design Review: 21-110264-LD

- Mixed-Use Medical-Residential
- 5 Stories
- 2,900 SF Medical Office
- 14 Dwelling Units
- 18 Parking Spaces

Contact: Geng Tan 206-488-3688

City of Bellevue Contact: Amy Tarce
425-452-2896 or atarce@bellevuewa.gov



4. Spring District – Block 15

12343 NE Spring Boulevard Lot 15

Design Review: 21-122598-LD

- Office Building
- 11 Stories
- 380,750 SF Office
- 1,070 Parking Spaces

Contact: Carolyn Wennblom 206-805-5830

City of Bellevue Contact: Kimo Burden
425-452-5242 or cburden@bellevuewa.gov



5. Amity Court

14400 NE Bellevue Redmond Road

Design Review: 22-114102-LD

- Multi-Family Residential
- 8 Stories
- 201 Residential Units
- 203 Parking Spaces

Contact: Karla Gonzalez 360-244-4661

City of Bellevue Contact:
Leticia Wallgren 425-452-2044 or
lwallgren@bellevuewa.gov



6. Stellar

13013 NE 20th Street

Design Review: 22-128140-LD

- Mixed-Use Residential Building
- 7 Stories
- 187 Residential Units
- 110 Underground Parking Spaces
- 3300 Sf Ground Level Retail

Contact: Jon O'Hare 425- 301-9542

City of Bellevue Contact: Amy Tarce
425-452-2896 or atarce@bellevuewa.gov



7. ACST Bellevue Pine Forest (MDP)

1445 120th Avenue NE

- Mixed-Use Office and Residential
- 2 Office buildings
- 4 Residential Buildings
- 8.43-acre site
- Approximately 889,900 SF of development
- Approximately 1,390 Parking stalls

Contact:

Tiffany Brown 425-454-1900 x234

City of Bellevue Contact: Laurie Tyler
425-452-2728 or ltyler@bellevuewa.gov



8. ACST-Bellevue Phase 1 Gables

1445 120th Avenue NE

Design Review: 23-100797-LD

- Multi-family Residential
- 1 Building
- 7 stories
- 274 market rate units
- 217 parking stalls

Contact: Jon O'Hare 425-301-95411

City of Bellevue Contact: Mark C. Brennan
425-452-2973 or
mcbrennan@bellevuewa.gov



9. ACST-Bellevue Phase 2

1215 120th Avenue NE

Design Review: 23-105964-LD

- Multi Family Residential
- 7 Stories
- 116 Units
- 89 Parking Spaces

Contact: Nicole Winn 206-344-57001

**City of Bellevue Contact: Komal Agarwal
425-452-7224 or
kagarwal@bellevuewa.gov**



10. ACST-Bellevue Phase 3

11957 NE Spring Blvd. and 1425 10th Ave NE

Design Review: 23-101061-LD

- One 8-story Office/Life Science Building
- One 9-story Office/Life Science Buildings
- 916 Parking Spaces
- 12,172 SF Ground Level Retail

Contact: Jarod Kurzner 425-523-7248

**City of Bellevue Contact: Amy Tarce
425-452-2896 or atarce@bellevuewa.gov**



11. 88 Degrees

1733 127th Avenue NE

Building Permits, multiple

- Residential Townhomes
- 80 Residential Units in 16 Buildings
- 160 Parking Spaces

Contact: Ryan Kohlmann 425-216-3428

City of Bellevue Contacts: Kimo Burden
425-452-5242 or cburden@bellevuewa.gov
and Miranda Riordan 425-452-6880 or
mriordan@bellevuewa.gov



12. Springvue Townhomes

12727 Northup Way

Design Review: 23-118447-LP,
23-118452-LD, 23-118446-LO

- 16 Multi-family Residential Buildings
- 3 stories
- 91 Townhome Units
- 182 Parking Spaces

Contact: Lindsey Solorio 425-885-7877

City of Bellevue Contact:
Riley MacPhee 425-452-4639 or
rmacphee@bellevuewa.gov



13. Bridge OMFE Affordable Housing

1899 120th Avenue NE

Design Review: 23-126561-LD

- Two Buildings (North and South)
6 Stories North / 7 Stories South
- 234 Total Units
83 Units North / 150 Units South
- 82 Total Parking Spaces
25 North / 57 South

Contact: Jon O'Hare 425-302-9541

City of Bellevue Contact: Leticia Wallgren
425-452-2044 or lwallgre@bellevuewa.gov



14. KOZ on Bel-Red

13800 NE Bel-Red Road

Design Review: 23-111025-LD

- Multi-family Residential
- 6 Stories
- 188 Units
- 37 Parking Spaces

Contact: Travis Morton 406-581-4177

City of Bellevue Contact:
Richard Hansen 425-452-2739 or
rhansen@bellevuewa.gov



15. 91 Degrees Townhomes

12951 NE Bel-Red Road

Design Review: 23-110915-LD

23-110918-LO

- Multi-Family Residential
- 4 Building
- 4 Stories
- 19 Townhome Units
- Attached Garage with Units
- 7 Guest Parking Stalls

Contact: Justin Goroch 253-627-4367

City of Bellevue Contact:

**Miranda Riordan 425-452-6889 or
mriordan@bellevuewa.gov**



Under Construction

1. East Link Bel-Red/130th Station

NE 16th between 130th and
132nd Avenue NE

- Transit Station
- 300-stall park and ride lot

Contact:

Sound Transit 206-398-5465

City of Bellevue Contact: Toni Pratt
425-452-5374 or tpratt@bellevuewa.gov



2. RJ Development Senior Housing

2120 116th Avenue NE

- Residential Buildings - Assisted Living
- Building A: 3 stories/ 60 units
- Building B: 5 stories/80 units
- 77 Parking Spaces

Contact:

Frank Durocher 360-528-3343

City of Bellevue Contact: Toni Pratt
425-452-5374 or tpratt@bellevuewa.gov



3. East Link Spring District/ 120th Station

North of Spring Boulevard between 120th & 124th Avenues NE

- New Transit Station to support East Link light rail
- Located below plaza level to support redevelopment plans

Contact: Sound Transit 206-398-5465

**City of Bellevue Contact: Toni Pratt
425-452-5374 or tpratt@bellevuewa.gov**



4. Northup Way Mixed Use

12863 Northup Way

- Mixed-Use Residential Building
- 9 Stories
- 402 Residential Units
(81 Affordable Units)
- 6,540 SF Ground Level Retail
- 364 Parking Spaces

Contact:

Epaminondas Trimis 425-454-0566 X202

**City of Bellevue Contact: Kimo Burden
425-452-5242 or cburden@bellevuewa.gov**



5. Spring District – Block 5

1615 123rd Avenue NE, Lot 5

- Office Building
- 11 Stories
- 327,000 SF Office
- 4,500 SF Retail
- 462 Parking Spaces

Contact:

Carolyn Wennblom 206-805-5830

**City of Bellevue Contact: Laurie Tyler
425-452-5758 or ltyler@bellevuewa.gov**



6. Big 1 Residential

13000 NE Bellevue-Redmond Road

- Mixed-Use Residential Building
- 7 Stories
- 172 Units (11 Affordable Units)
- 8,154 SF Ground Level Retail
- 213 Parking Spaces

Contact: Blair Stone 260-290-1758

**City of Bellevue Contact: Drew Folsom
425-452-4441 or dfolsom@bellevuewa.gov**



7. Spring District – Block 13

1325 123rd Avenue NE

- Office Building
- 9 Stories
- 217,181 SF Office
- 270 Parking Spaces

Contact: Carolyn Wennblom 206-805-5830

City of Bellevue Contact: Laurie Tyler
425-452-2728 or lt Tyler@bellevuewa.gov



8. Ondina (formerly Summerhill)

13238 NE Spring Blvd

- Residential Building
- 7 Stories
- 250 Residential Units
- 163 Parking Spaces

Contact: Arne Hall 425-269-9899

City of Bellevue Contact:
Reilly Pittman 425-452-4350 or
rpittman@bellevuewa.gov



9. Bellevue Station

1525 132nd Avenue NE

- Mixed-Use Residential Building
- 8 Stories
- 298 Residential Units
- 9,600 SF Ground Level Retail
- 303 Parking Spaces

Contact: Derrick Overbay 206-240-0409

**City of Bellevue Contact: Drew Folsom
425-452-4441 or dfolsom@bellevuewa.gov**





In the Pipeline

(Pre-application Conference held)

1. Koz in Bel Red I 1302 NE Spring Blvd MDP

Issued

1. SummerHill Highland Park

14125 NE 20th Street

- Multi-Family Residential
- 2 Buildings
- 7 Stories per Building
- 397 Residential Units
(81 Affordable Units)
- 397 Parking Spaces

Contact:

Constanza Marcheselli 206-956-1970

City of Bellevue Contact: Drew Folsom
425-452-4441 or dfolsom@bellevuewa.gov



2. Executive Plaza Townhomes

12835 NE Bellevue-Redmond Road

**Design Review & Critical Areas Land Use
Permit: 22-105005-LD & 22-105006-LO**

- Residential Townhomes
- 31 Units in 4 Buildings
- 64 Parking Spaces

Contact: Victoria Arthur 206-612-5508 x141

City of Bellevue Contact: Drew Folsom
425-452-4441 or dfolsom@bellevuewa.gov





For alternate formats, interpreters, or reasonable modification requests please phone at least 48 hours in advance 425-452-2973 (voice) or email mcbrennan@bellevuewa.gov. For complaints regarding modifications, contact the City of Bellevue ADA, Title VI, and Equal Opportunity Officer at ADATitleVI@bellevuewa.gov.